

# Daily Coordination Meeting



14:00 Sign In

# Daily Coordination Meeting

## General Topics:

- Proper Staffing
- Ensuring Everyone is Focused Between Holidays (“Head in the Game”)



# HSAI Concrete Pours

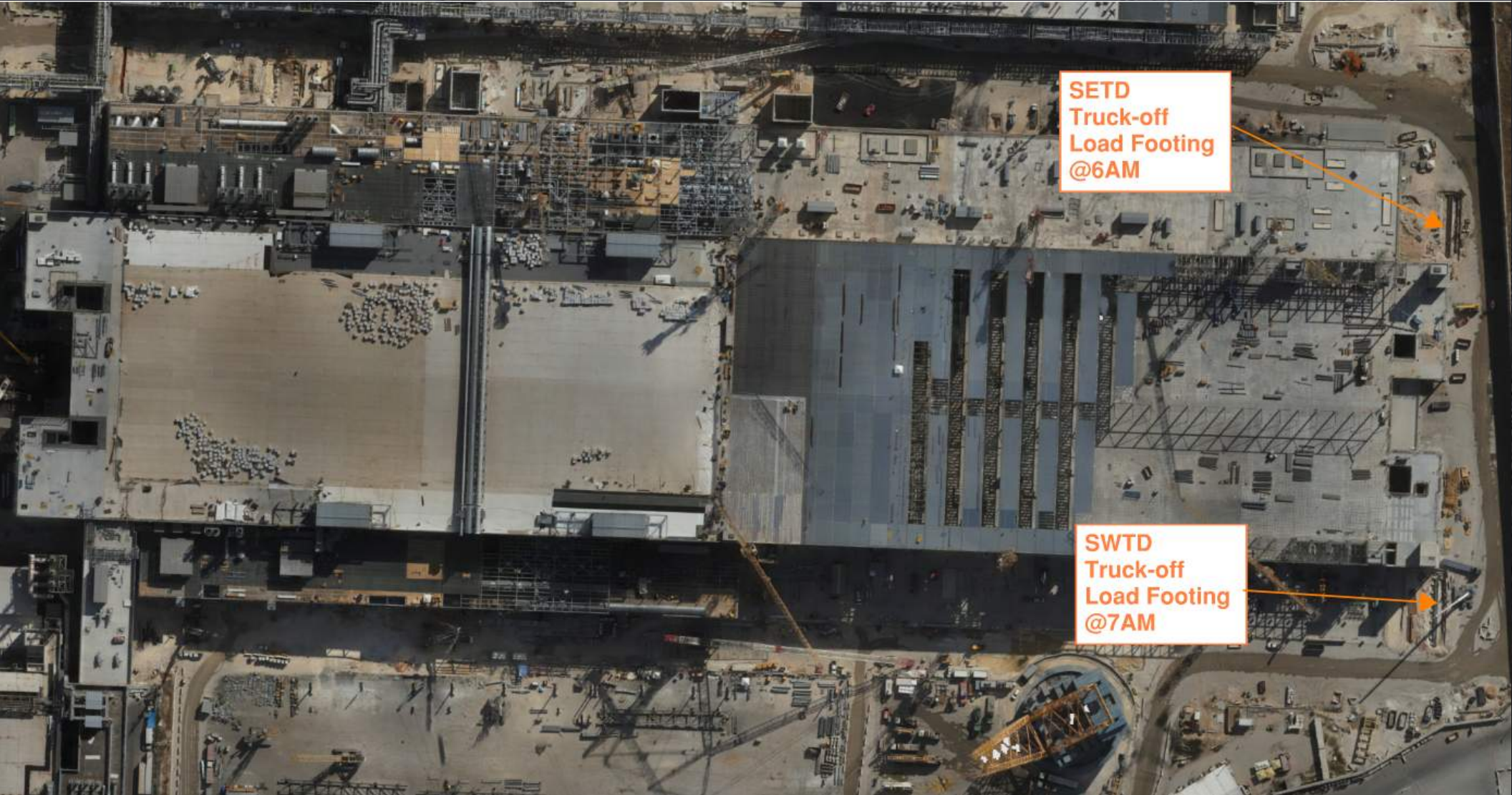

**SETD  
Truck-off  
Load Footing  
@6AM**

**SWTD  
Truck-off  
Load Footing  
@7AM**



# SUBFAB BUILDOUT MOD 1

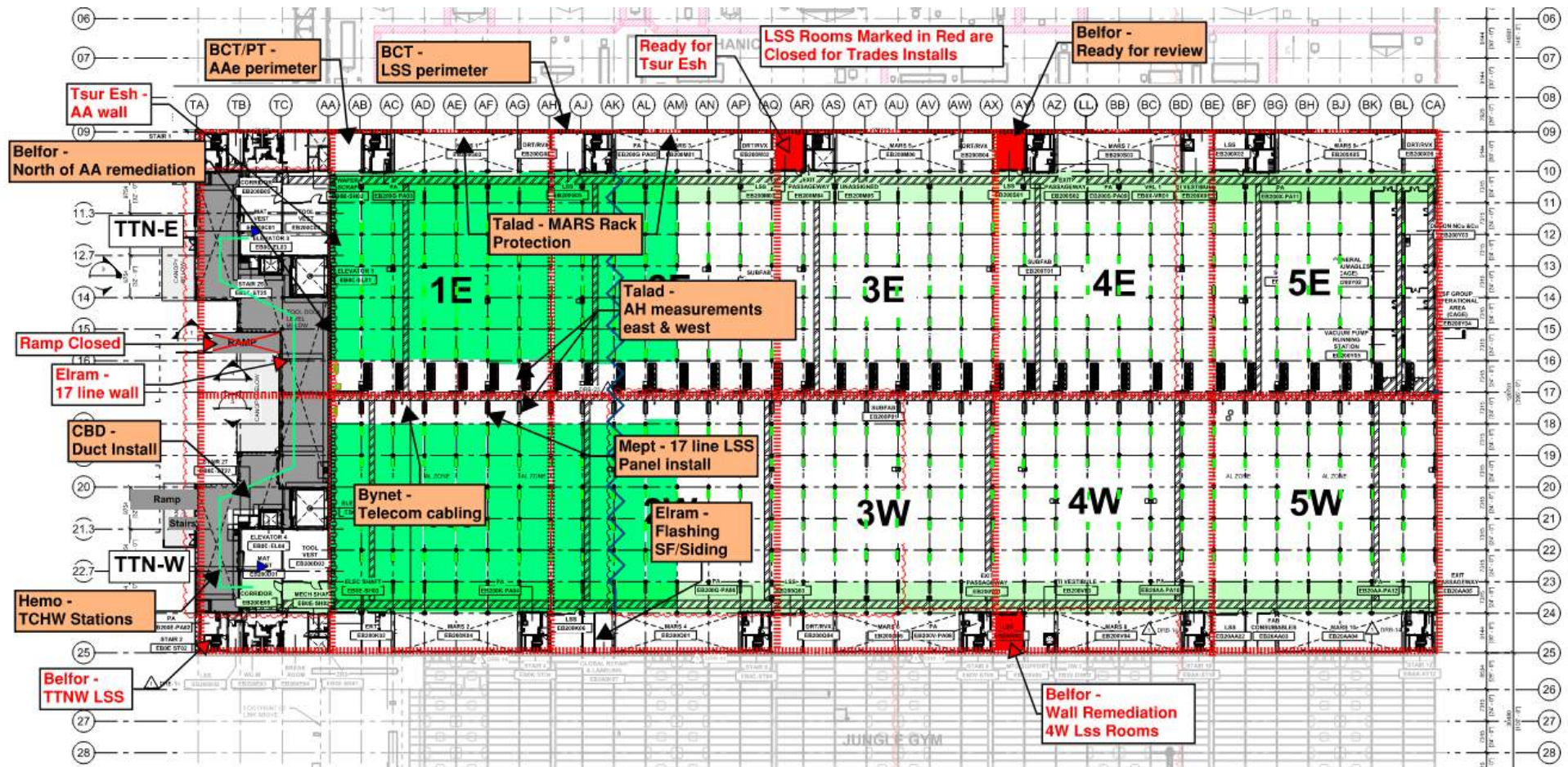

# SUBFAB CRC TOPCOAT

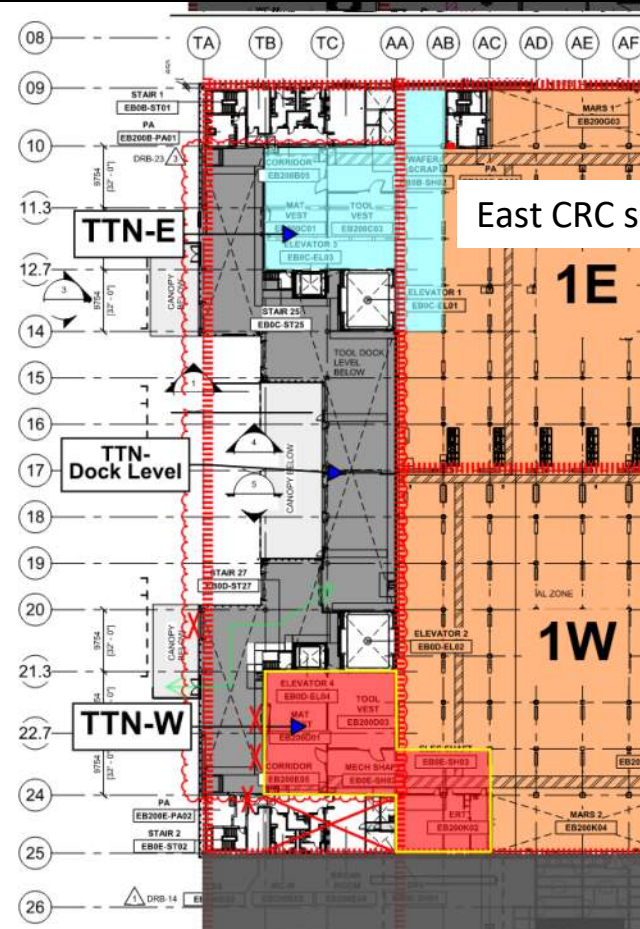

East CRC scheduled for 20/10



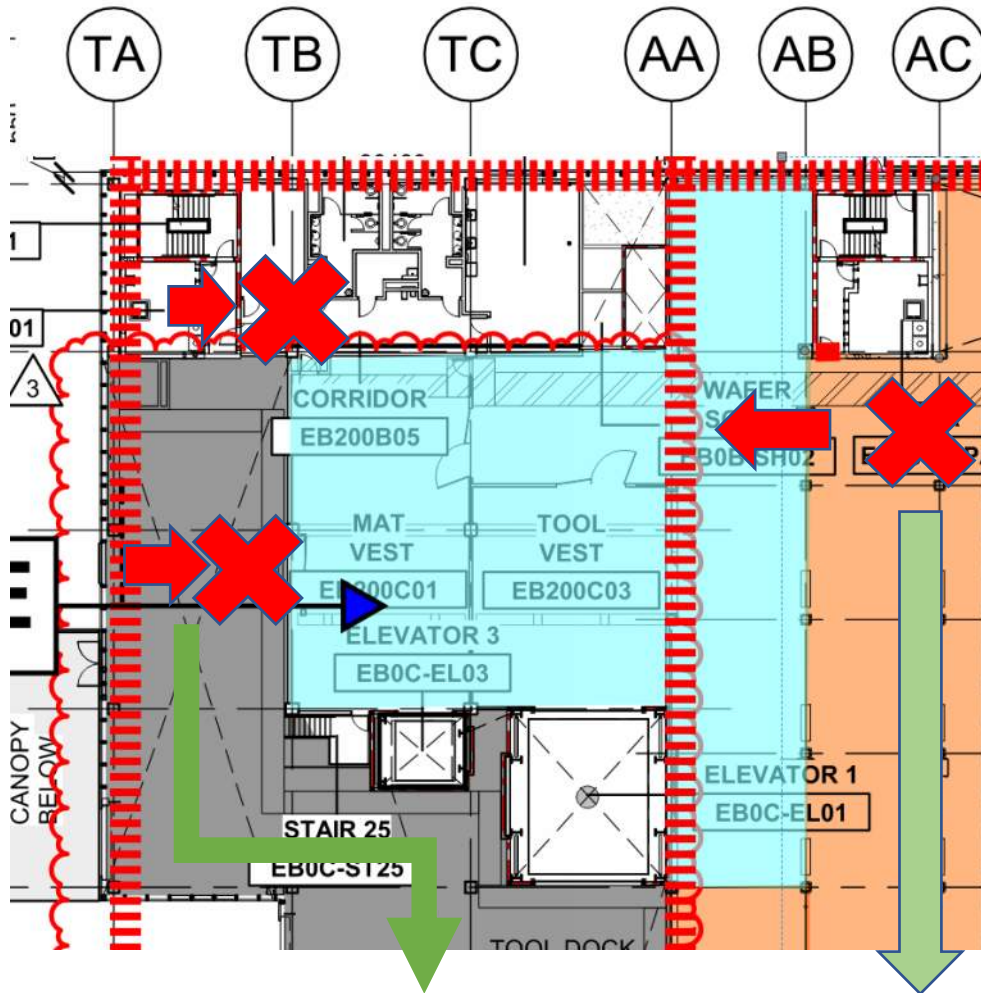

Sunday OCT 20<sup>th</sup>

CRC AAe & TTNE Upper Dock.

- Temp stairs – Access blocked.
- Stairs1 – Access blocked, SF level only.

# BCT Pressure Test Exclusion Zone

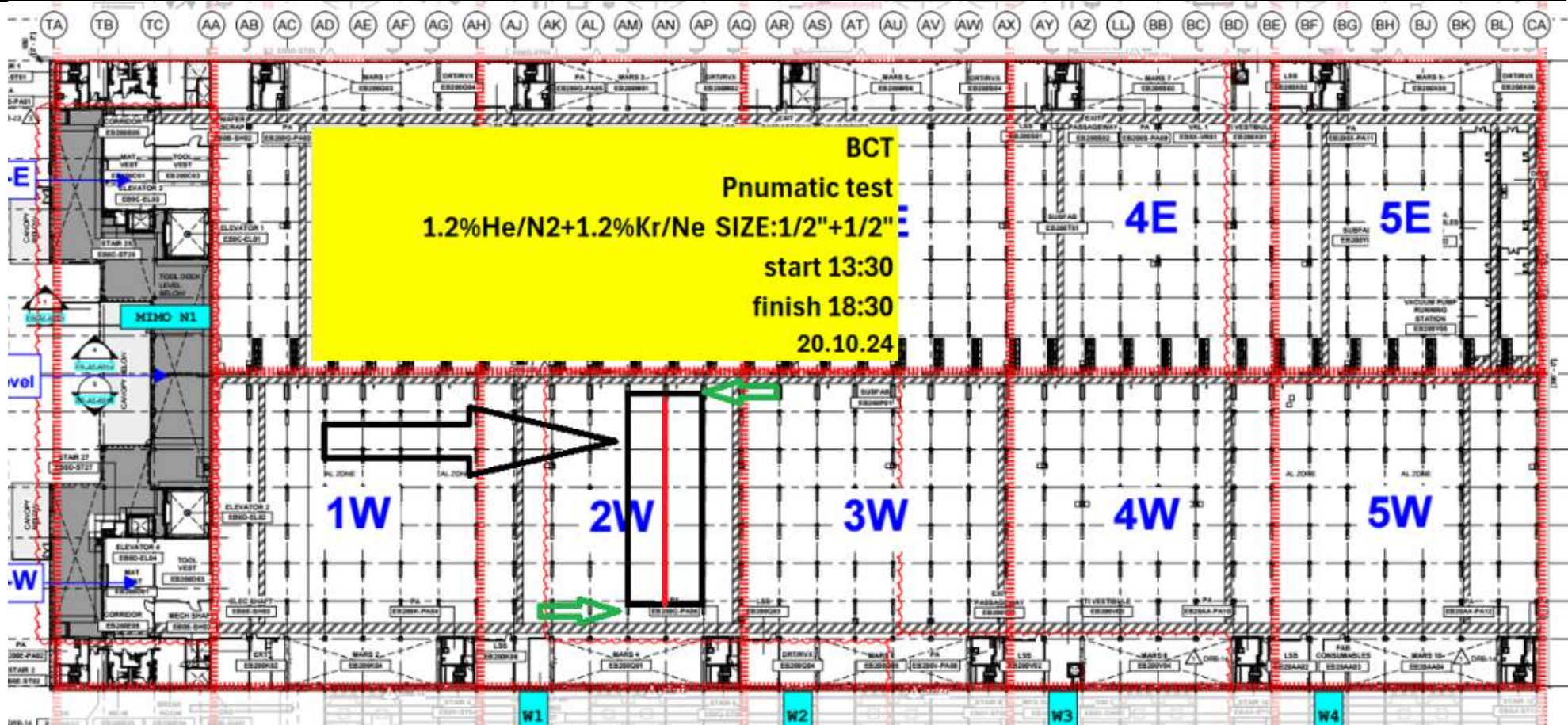





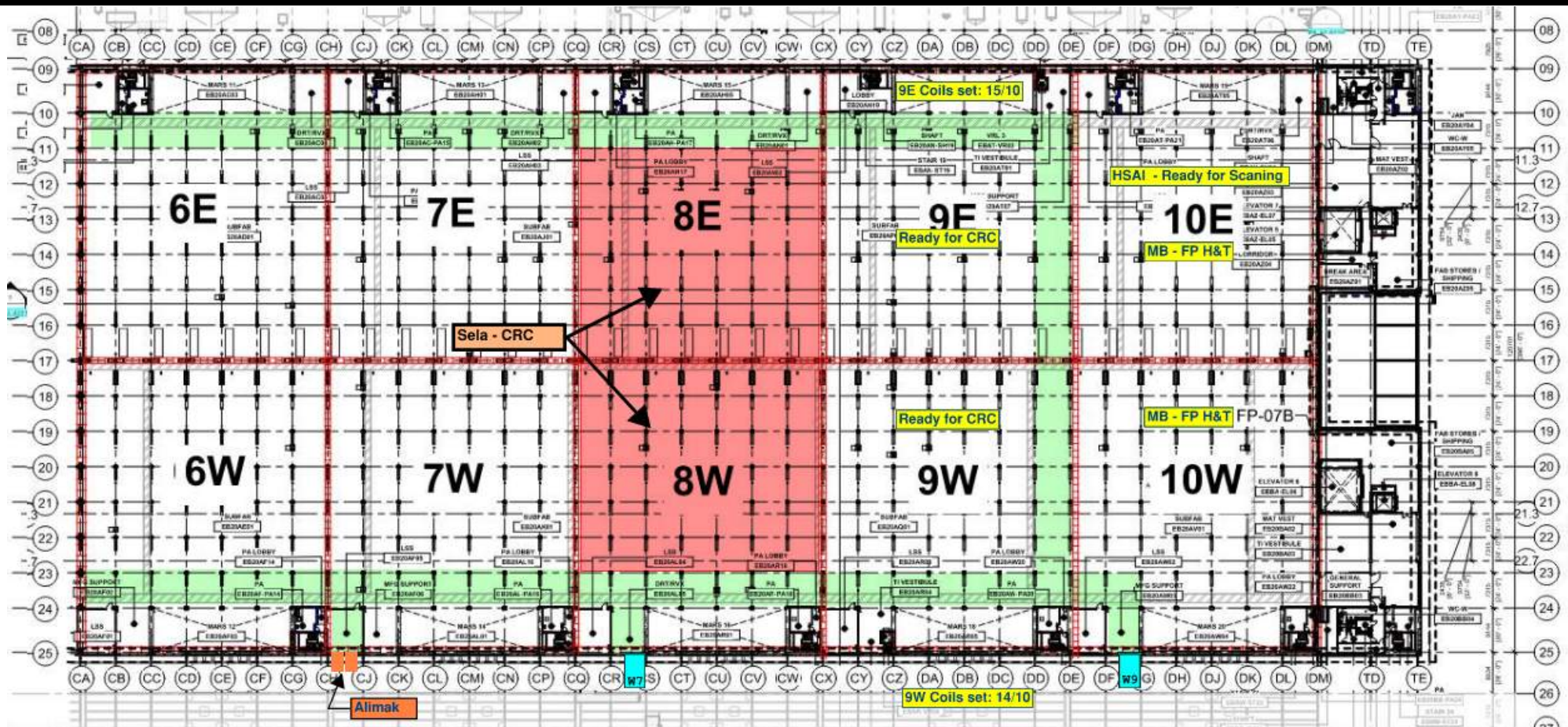







# SUBFAB BUILDOUT MOD 2





# Tavas + Talent solution

## P1 cleaning 1E

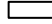
CR level:	
	<u>Afcon</u> - Cable trays, modules and stickers ,2E, 2W,3E,3W,4E
	<u>MB</u> - 1W drops. 2E- 2W pipes and drops
	<u>Elram</u> - 9-10,24-25 columns/shaft walls. AA line column wraps
	<u>WW/JS</u> - 17-18 line added beams+ AS south stocker beams
	<u>Meptagon</u> - I&C 2W
	<u>D&amp;P</u> - 5E blades install.
	<u>Tzur-esh</u> - 5E blades. 1W-1E shaft walls
	<u>HYG</u> - 5W Litho crane steel
	<u>PT</u> - Duct prep for test AA-AH east
	<u>Talad</u> - 1W 4DA holes drilling, 1W cutting around steel,17 line bracing
	<u>TMT</u> - Safety net install

D&P blades  
install

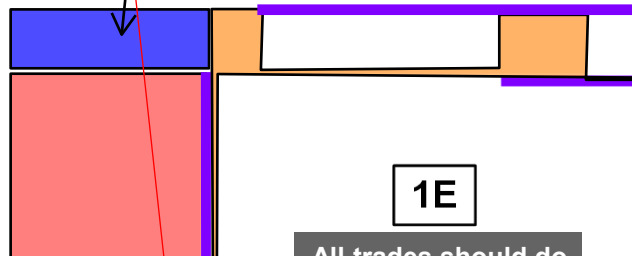

1E

All trades should do training and the have correct equipment to work in this area

2E

3E

4E

5E

Elram- AA line columns+G1 wall mock-up  
Chemo- Hangers install  
SN - Beams layout

SELA-crc spraying17 aa-ak

Talad-ongoing beam bracing across 17 line+aa/ab

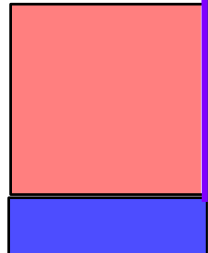

2

1

3

2W

3W

4W

5 N

L  
I  
N  
K

Link  
Pach-Taas – exhaust duct install and tie in  
SIG- Mobile scaffold install  
Afcon- Rack install  
Newcotech- temp wall  
Afcon – cable tray & racks install

Sella's next prepped areas.

ELRAM  
finishing  
columns  
wrapping  
9 line and  
tt columns

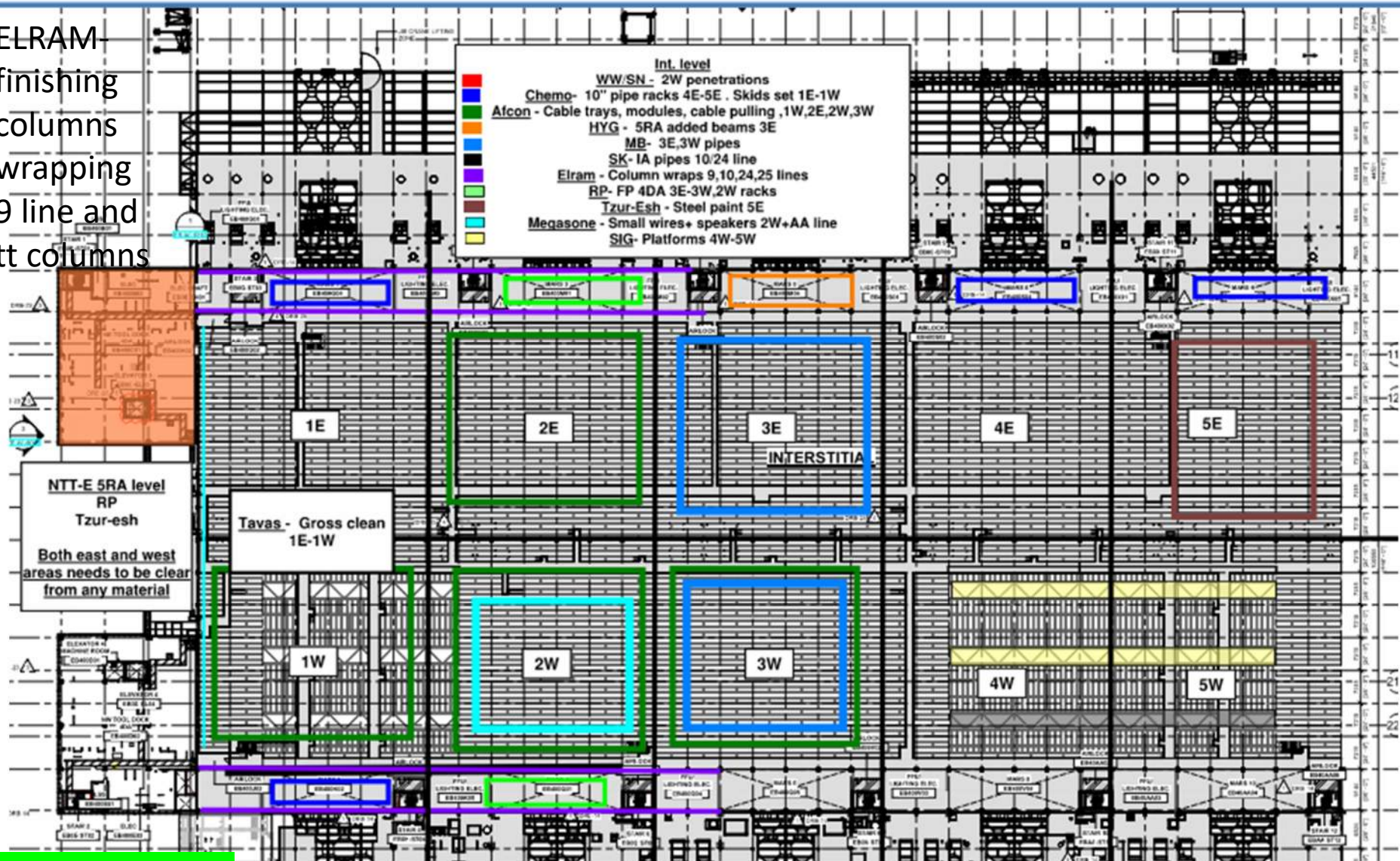

Nwtt-Rpc+tsur-esh  
Fire proofing and  
painting 5ra beams





## MOD 2 STEEL ERECTION

Truss Yard:  
RP and Tzur-Esh to start FP and paint trusses on night shift

Infill ongoing

Tzur-esh  
MOD2 paint

MIMO 4DA level CB-CC  
SIG done

TRUSS #21  
EAST SIDE  
MONDDAY 04:00.

SEQ 282 ongoing

NEW DUMPSTER ON  
TOP OF MIMO

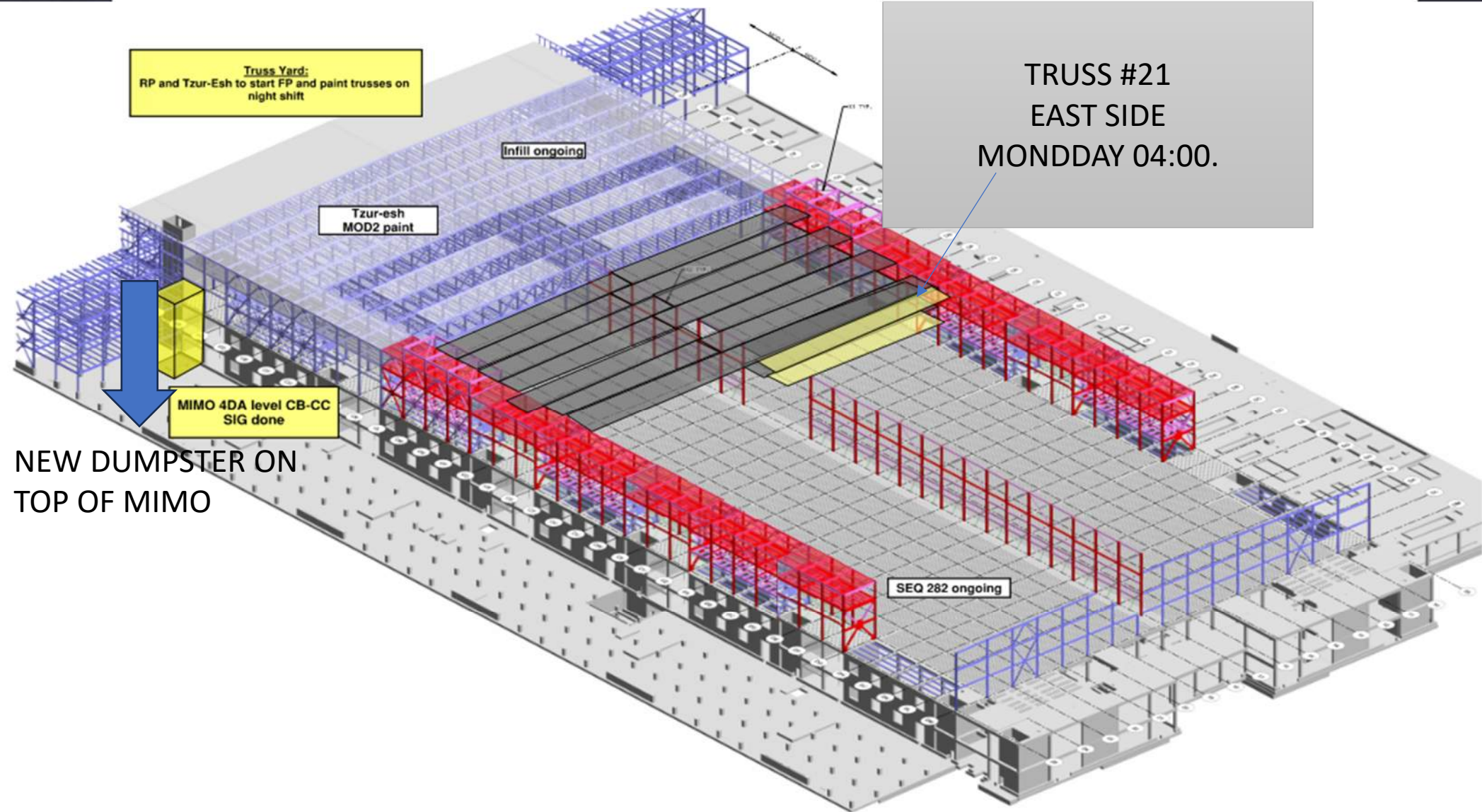



## Clean Room Wall Of Shame





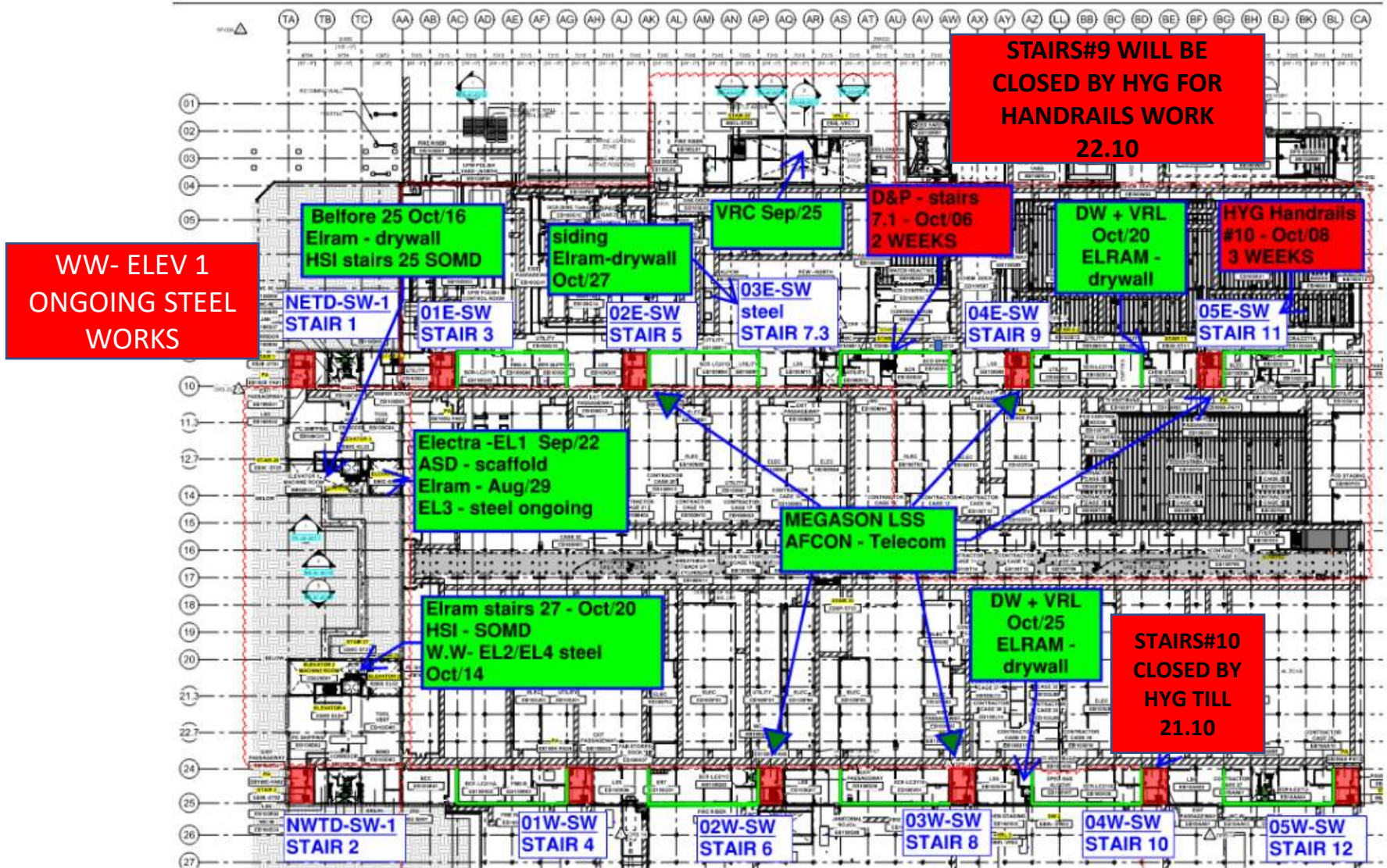

WW- ELEV 1  
ONGOING STEEL  
WORKS

Before 25 Oct/16  
Elram - drywall  
HSI stairs 25 SOMD

NETD-SW-1  
STAIR 1

01E-SW  
STAIR 3

siding  
Elram-drywall  
Oct/27

VRC Sep/25

03E-SW  
steel STAIR 7.3

D&P - stairs  
7.1 - Oct/06  
2 WEEKS

DW + VRL  
Oct/20  
ELRAM -  
drywall

HYG Handrails  
#10 - Oct/08  
3 WEEKS

04E-SW  
STAIR 9

05E-SW  
STAIR 11

Electra - EL1 Sep/22  
ASD - scaffold  
Elram - Aug/29  
EL3 - steel ongoing

MEGASON LSS  
AFCON - Telecom

Elram stairs 27 - Oct/20  
HSI - SOMD  
W.W- EL2/EL4 steel  
Oct/14

DW + VRL  
Oct/25  
ELRAM -  
drywall

STAIRS#9 WILL BE  
CLOSED BY HYG FOR  
HANDRAILS WORK  
22.10

STAIRS#10  
CLOSED BY  
HYG TILL  
21.10

NWTD-SW-1  
STAIR 2

01W-SW  
STAIR 4

02W-SW  
STAIR 6

03W-SW  
STAIR 8

04W-SW  
STAIR 10

05W-SW  
STAIR 12



Siding - West FAB - JYG

BLOWDOWN 30%

[illegible]



Siding - East FAB -

BLOWDOWN 30%

	CA	CB	CC	CD	CE	CF	CG	CH	CI	CJ	CK	CL	CM	CN	CO	CP	CQ	CR	CS	CT	CU	CV	CW	CX	CY	CZ	DA	DB	DC	DD	DE	DF	DG	DH	DI	DJ	DK	DL	DM	DN	DO	DP	DQ	DR	DS	DT	DU	DV	DW	DX	DY	DZ	EA	EB	EC	ED	EE	EF	EG	EH	EI	EJ	EK	EL	EM	EN	EO	EP	EQ	ER	ES	ET	EU	EV	EW	EX	EY	EZ	FA	FB	FC	FD	FE	FF	FG	FH	FI	FJ	FK	FL	FM	FN	FO	FP	FQ	FR	FS	FT	FU	FV	FW	FX	FY	FZ	GA	GB	GC	GD	GE	GF	GG	GH	GI	GJ	GK	GL	GM	GN	GO	GP	GQ	GR	GS	GT	GU	GV	GW	GX	GY	GZ	HA	HB	HC	HD	HE	HF	HG	HH	HI	HJ	HK	HL	HM	HN	HO	HP	HQ	HR	HS	HT	HU	HV	HW	HX	HY	HZ	IA	IB	IC	ID	IE	IF	IG	IH	II	IJ	IK	IL	IM	IN	IO	IP	IQ	IR	IS	IT	IU	IV	IW	IX	IY	IZ	JA	JB	JC	JD	JE	JF	JG	JH	JI	IJ	JK	JL	JM	JN	JO	JP	JQ	JR	JS	JT	JU	JV	JW	JX	JY	JZ	KA	KB	KC	KD	KE	KF	KG	KH	KI	KJ	KK	KL	KM	KN	KO	KP	KQ	KR	KS	KT	KU	KV	KW	KX	KY	KZ	LA	LB	LC	LD	LE	LF	LG	LH	LI	LJ	LK	LM	LN	LO	LP	LQ	LR	LS	LT	LU	LV	LW	LX	LY	LZ	MA	MB	MC	MD	ME	MF	MG	MH	MI	MJ	MK	ML	MM	MN	MO	MP	MQ	MR	MS	MT	MU	MV	MW	MX	MY	MZ	NA	NB	NC	ND	NE	NF	NG	NH	NI	NJ	NK	NL	NM	NN	NO	NP	NQ	NR	NS	NT	NU	NV	NW	NX	NY	NZ	OA	OB	OC	OD	OE	OF	OG	OH	OI	OJ	OK	OL	OM	ON	OO	OP	OQ	OR	OS	OT	OU	OV	OW	OX	OY	OZ	PA	PB	PC	PD	PE	PF	PG	PH	PI	PJ	PK	PL	PM	PN	PO	PP	PQ	PR	PS	PT	PU	PV	PW	PX	PY	PZ	QA	QB	QC	QD	QE	QF	QG	QH	QI	QJ	QK	QL	QM	QN	QO	QP	QQ	QR	QS	QT	QU	QV	QW	QX	QY	QZ	RA	RB	RC	RD	RE	RF	RG	RH	RI	RJ	RK	RL	RM	RN	RO	RP	RQ	RR	RS	RT	RU	RV	RW	RX	RY	RZ	SA	SB	SC	SD	SE	SF	SG	SH	SI	SJ	SK	SL	SM	SN	SO	SP	SQ	SR	SS	ST	SU	SV	SW	SX	SY	SZ	TA	TB	TC	TD	TE	TF	TG	TH	TI	TJ	TK	TL	TM	TN	TO	TP	TQ	TR	TS	TT	TU	TV	TW	TX	TY	TZ	UA	UB	UC	UD	UE	UF	UG	UH	UI	UJ	UK	UL	UM	UN	UO	UP	UQ	UR	US	UT	UU	UV	UW	UX	UY	UZ	VA	VB	VC	VD	VE	VF	VG	VH	VI	VJ	VK	VL	VM	VN	VO	VP	VQ	VR	VS	VT	VU	VV	VW	VX	VY	VZ	WA	WB	WC	WD	WE	WF	WG	WH	WI	WJ	WK	WL	WM	WN	WO	WP	WQ	WR	WS	WT	WU	WV	WW	WX	WY	WZ	XA	XB	XC	XD	XE	XF	YG	YH	YI	YJ	YK	YL	YM	YN	YO	YP	YQ	YR	YS	YT	YU	YV	YW	YX	YY	YZ	ZA	ZB	ZC	ZD	ZE	ZF	ZG	ZH	ZI	ZJ	ZK	ZL	ZM	ZN	ZO	ZP	ZQ	ZR	ZS	ZT	ZU	ZV	ZW	ZX	ZY	ZZ
	761/762		741/742		731/732		721/722		711/712		561/562		541/542		531/532		521/522		511/512		501/502		961/962																																																																																																																																																																																																																																																																																																																																																																																																																																																																																																																																																																																														
	24	24	24	24	24	24	24	24	24	24	24	24	24	24	24	24	24	24	24	24	24	24	24	24	24	24	24	24	24	24	24	24	24	24	24	24	24	24	24	24	24	24	24	24	24	24	24	24	24	24	24	24	24	24	24	24	24	24	24	24	24	24	24	24	24	24	24	24	24	24	24	24	24	24	24	24	24	24	24	24	24	24	24	24	24	24	24	24	24	24	24	24	24	24	24	24	24	24	24	24	24	24	24	24	24	24	24	24	24	24	24	24	24	24	24	24	24	24	24	24	24	24	24	24	24	24	24	24	24	24	24	24	24	24	24	24	24	24	24	24	24	24	24	24	24	24	24	24	24	24	24	24	24	24	24	24	24	24	24	24	24	24	24	24	24	24	24	24	24	24	24	24	24	24	24	24	24	24	24	24	24	24	24	24	24	24	24	24	24	24	24	24	24	24	24	24	24	24	24	24	24	24	24	24	24	24	24	24	24	24	24	24	24	24	24	24	24	24	24	24	24	24	24	24	24	24	24	24	24	24	24	24	24	24	24	24	24	24	24	24	24	24	24	24	24	24	24	24	24	24	24	24	24	24	24	24	24	24	24	24	24	24	24	24	24	24	24	24	24	24	24	24	24	24	24	24	24	24	24	24	24	24	24	24	24	24	24	24	24	24	24	24	24	24	24	24	24	24	24	24	24	24	24	24	24	24	24	24	24	24	24	24	24	24	24	24	24	24	24	24	24	24	24	24	24	24	24	24	24	24	24	24	24	24	24	24	24	24	24	24	24	24	24	24	24	24	24	24	24	24	24	24	24	24	24	24	24	24	24	24	24	24	24	24	24	24	24	24	24	24	24	24	24	24	24	24	24	24	24	24	24	24	24	24	24	24	24	24	24	24	24	24	24	24	24	24	24	24	24	24	24	24	24	24	24	24	24	24	24	24	24	24	24	24	24	24	24	24	24	24	24	24	24	24	24	24	24	24	24	24	24	24	24	24	24	24	24	24	24	24	24	24	24	24	24	24	24	24	24	24	24	24	24	24	24	24	24	24	24	24	24	24	24	24	24	24	24	24	24	24	24	24	24	24	24	24	24	24	24	24	24	24	24	24	24																																																																																																																

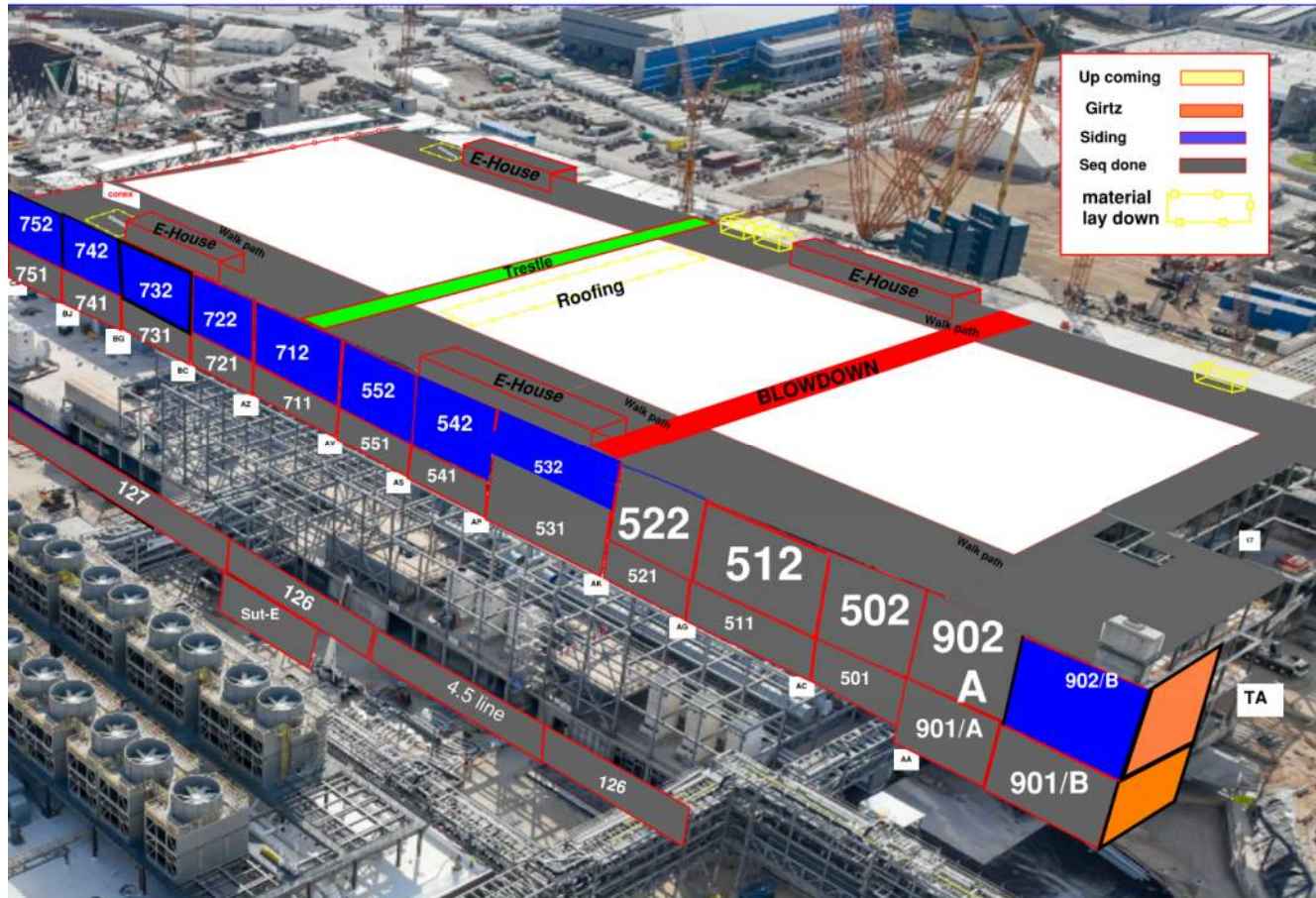



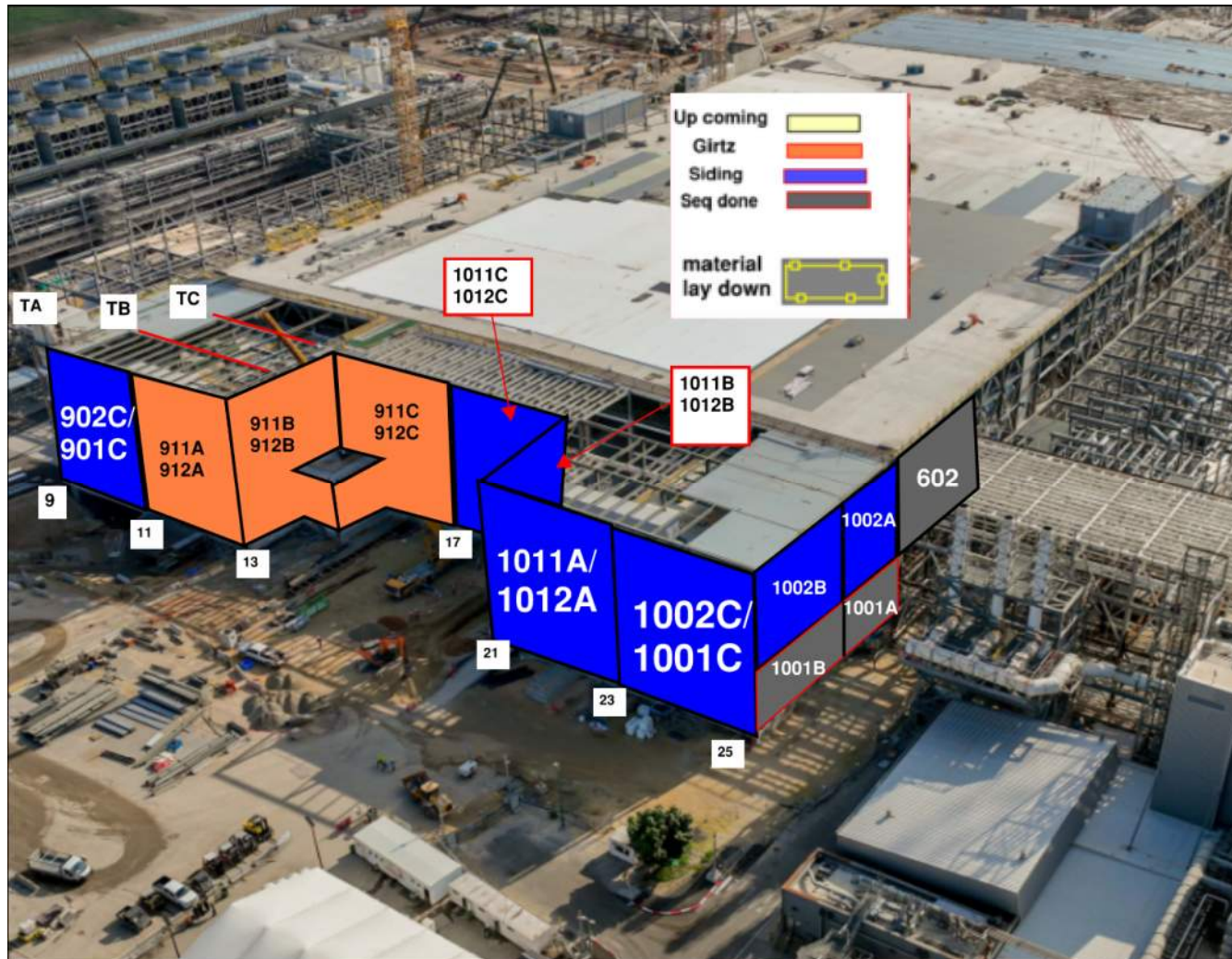

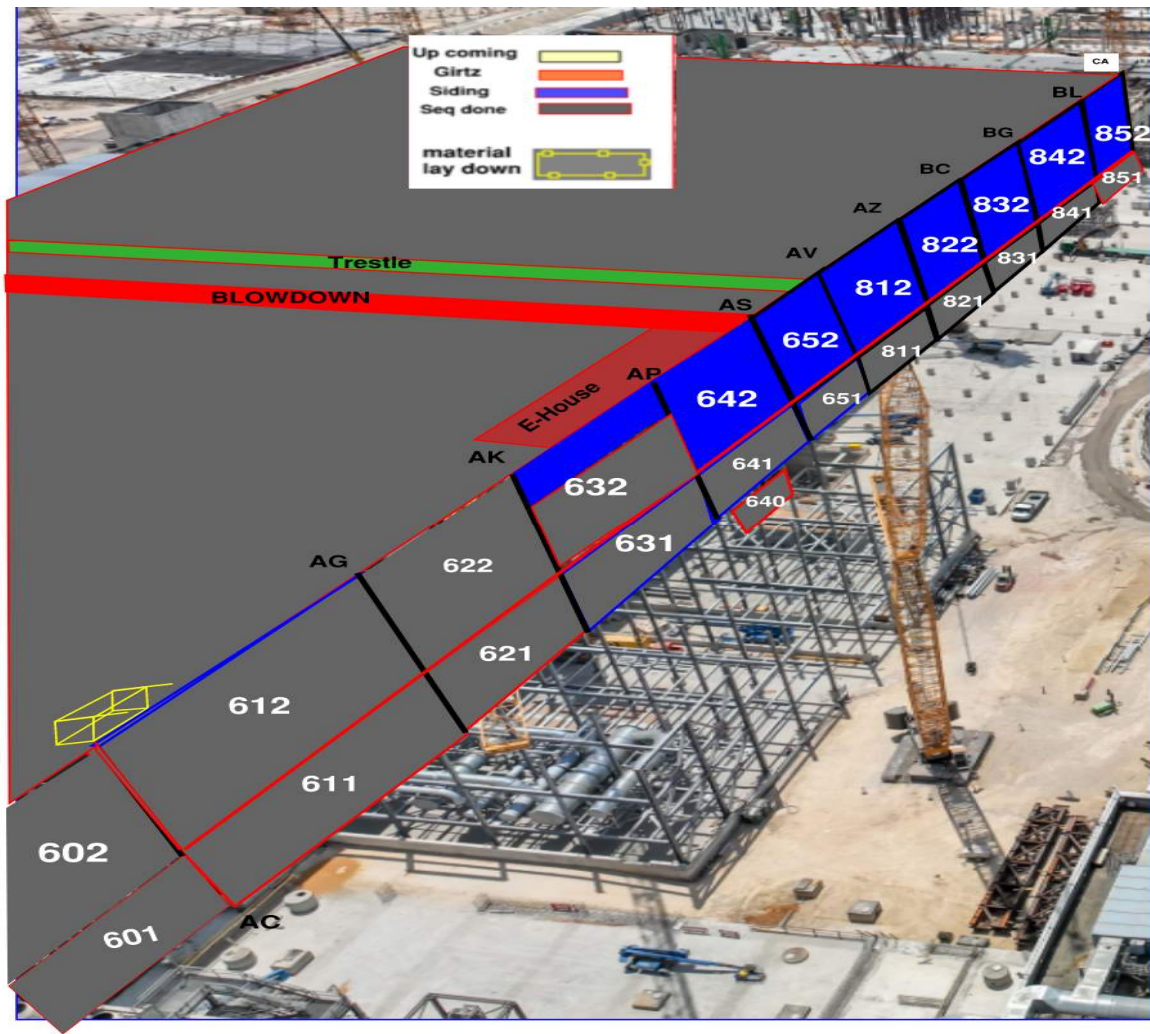



# PSSS.1

Utility Level  
1YA

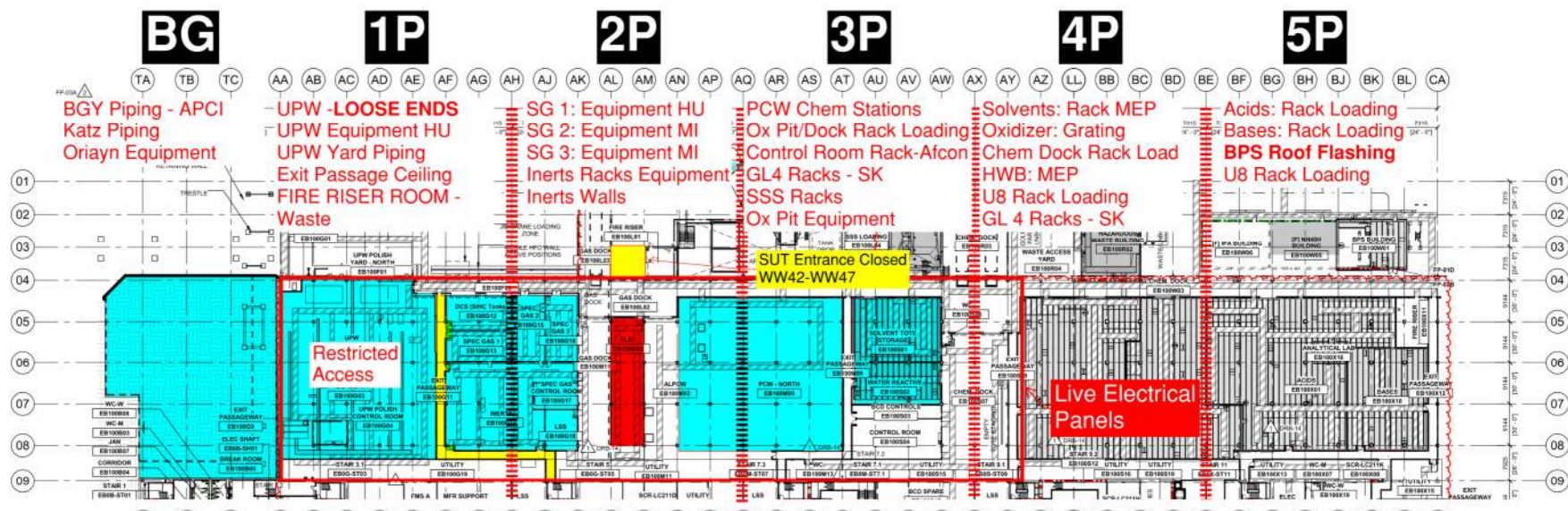

PSSS Roof  
2SA

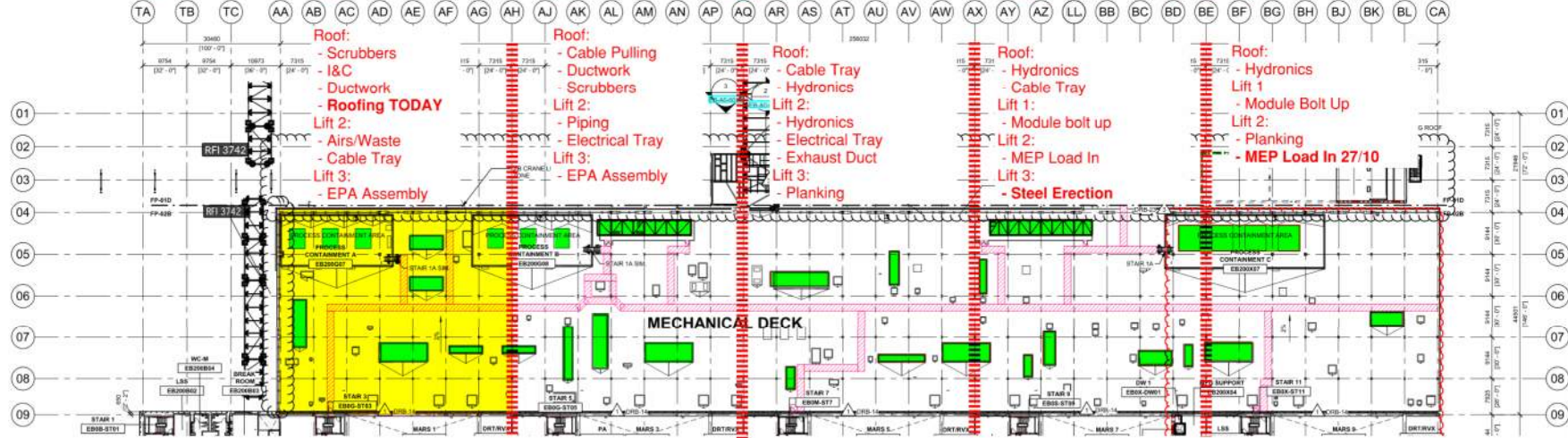



# PSSS.2

**10P**

## Utility Level 1YA

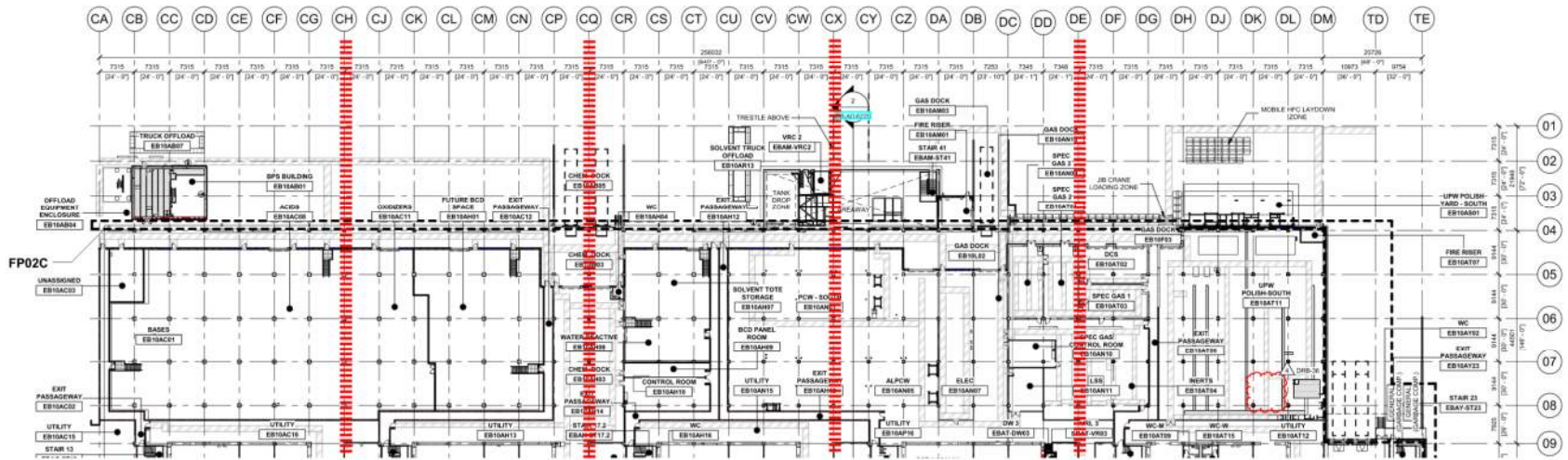

PSSS Roof  
2SA

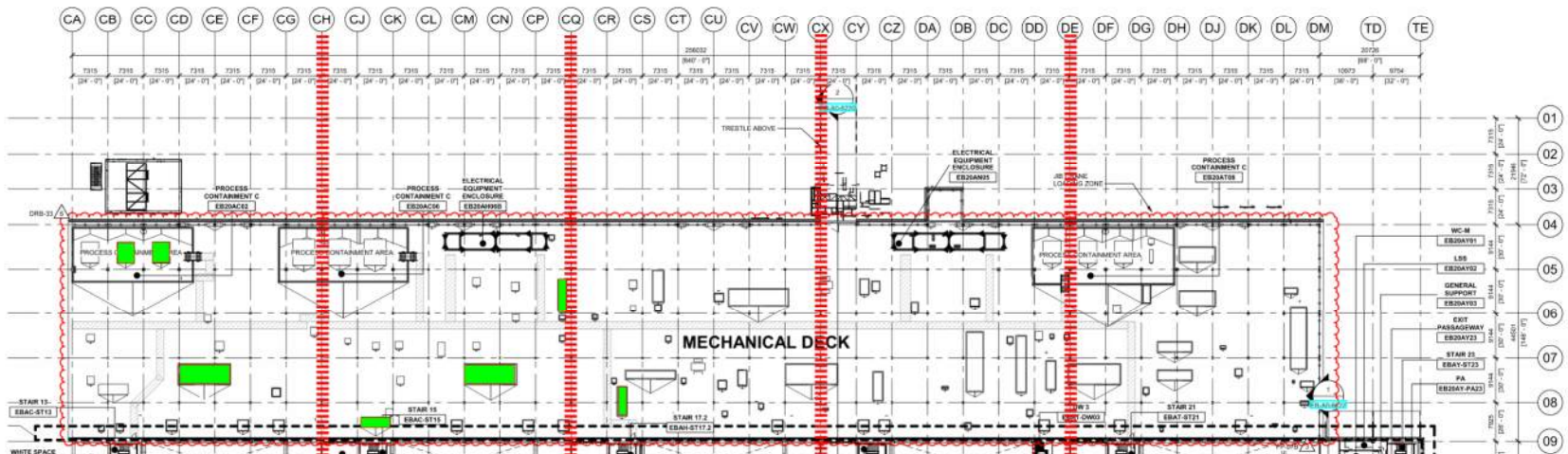



# DMAG MOVE FOR Plenum Set



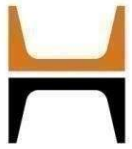

## WJG 01J, 02J LIFT 2 & 3







# WJG 03J, 04J, 05J LIFT 2 & 3





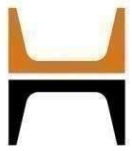

# WJG 03J Plenum Set

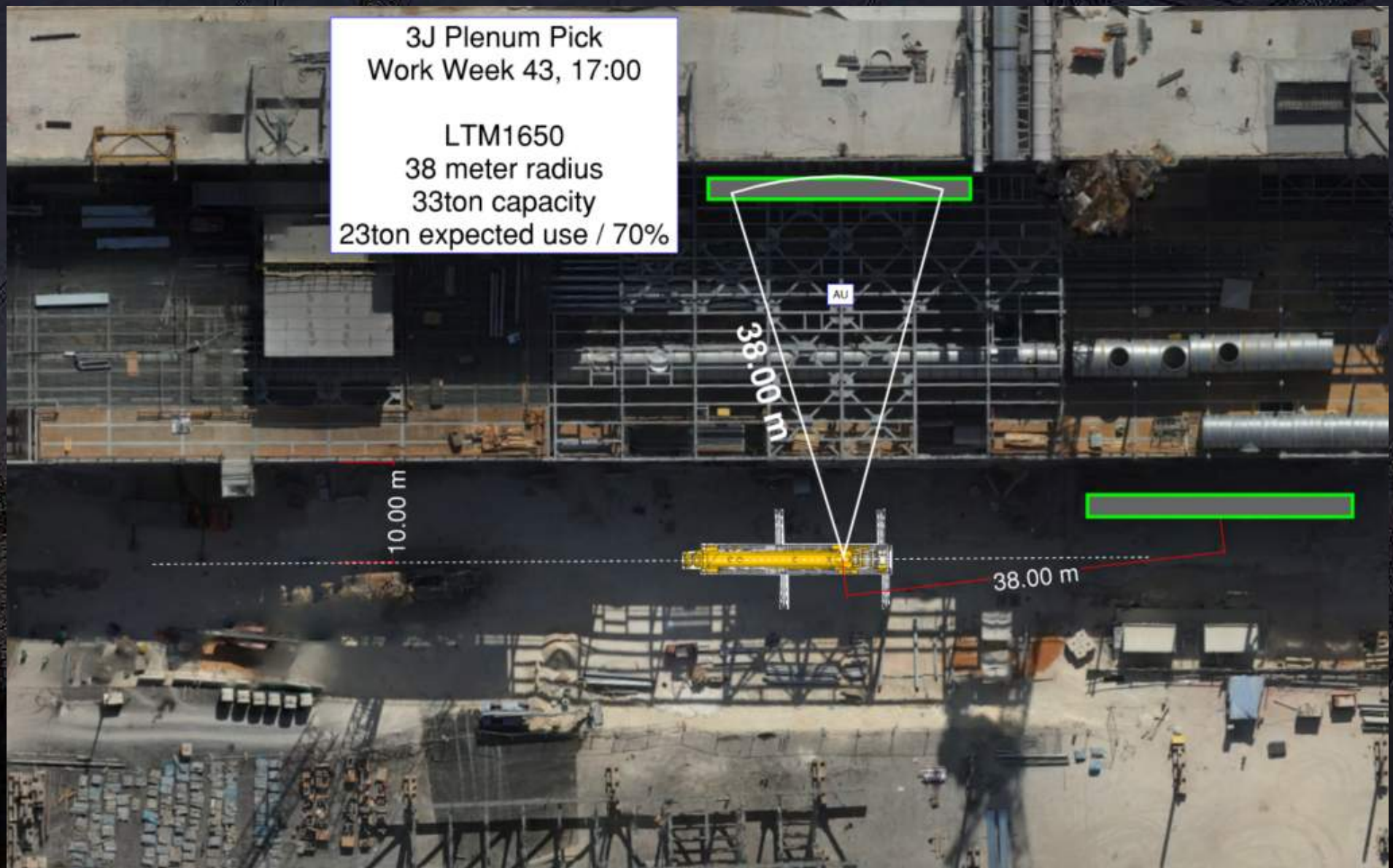



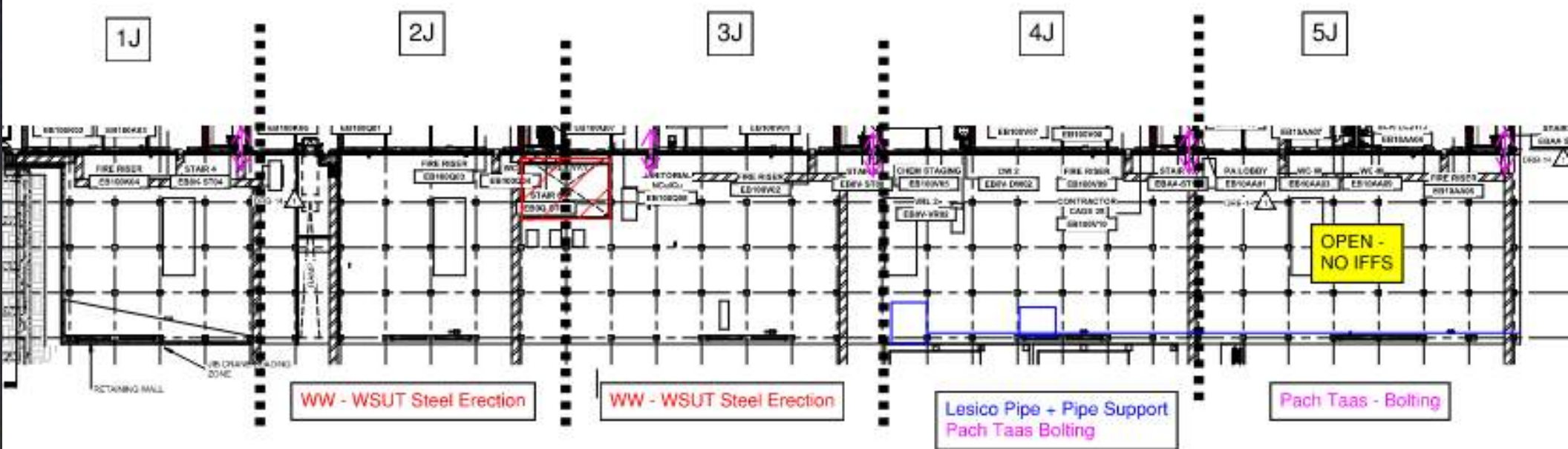



# CUB 1

## CUB 1 COORDINATION MAP

UPDATED

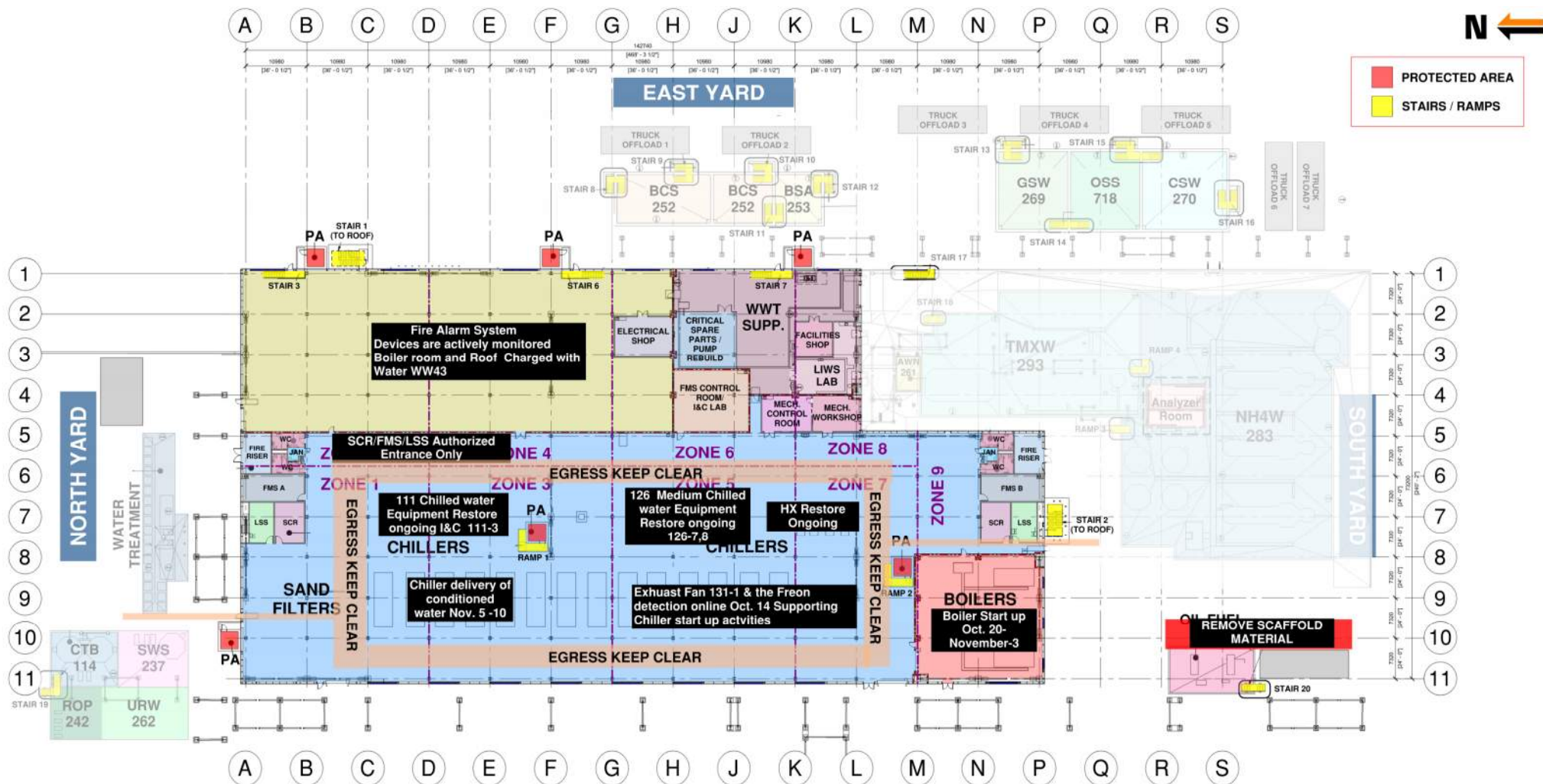



# CUB 1 – EXTERIOR/ROOF

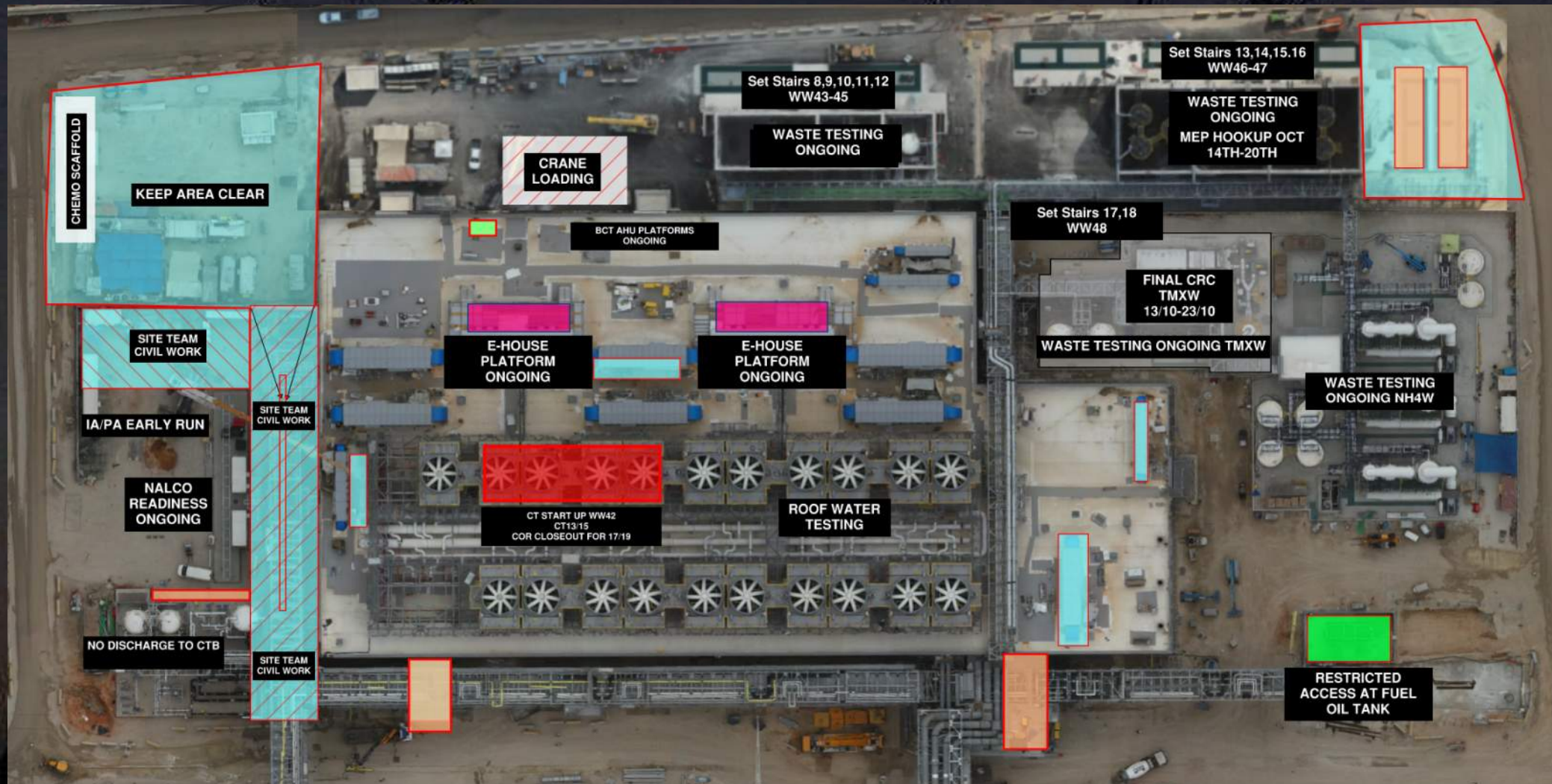





# CUB 2

## CUB 2 COORDINATION MAP

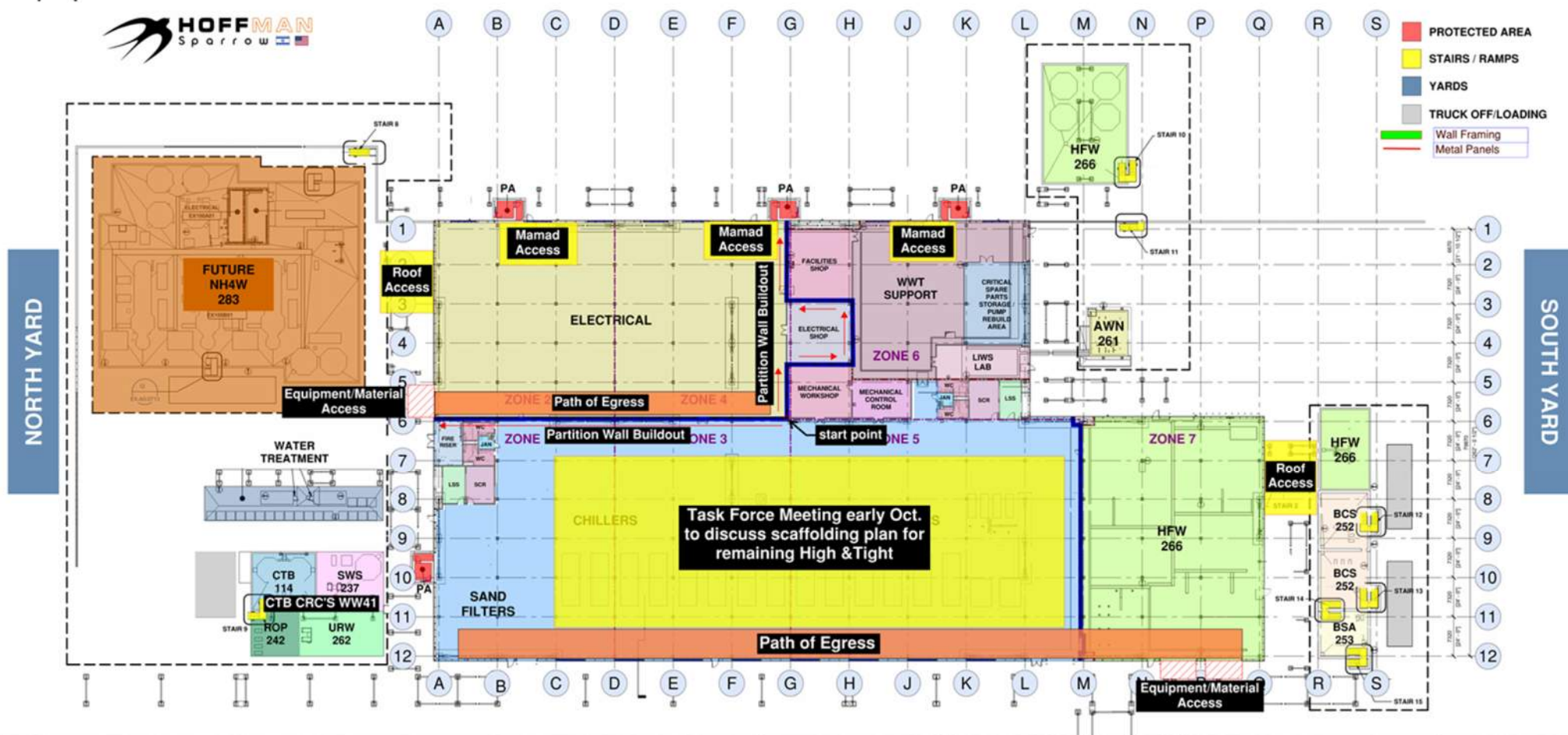



# CUB 2 – EXTERIOR/ROOF

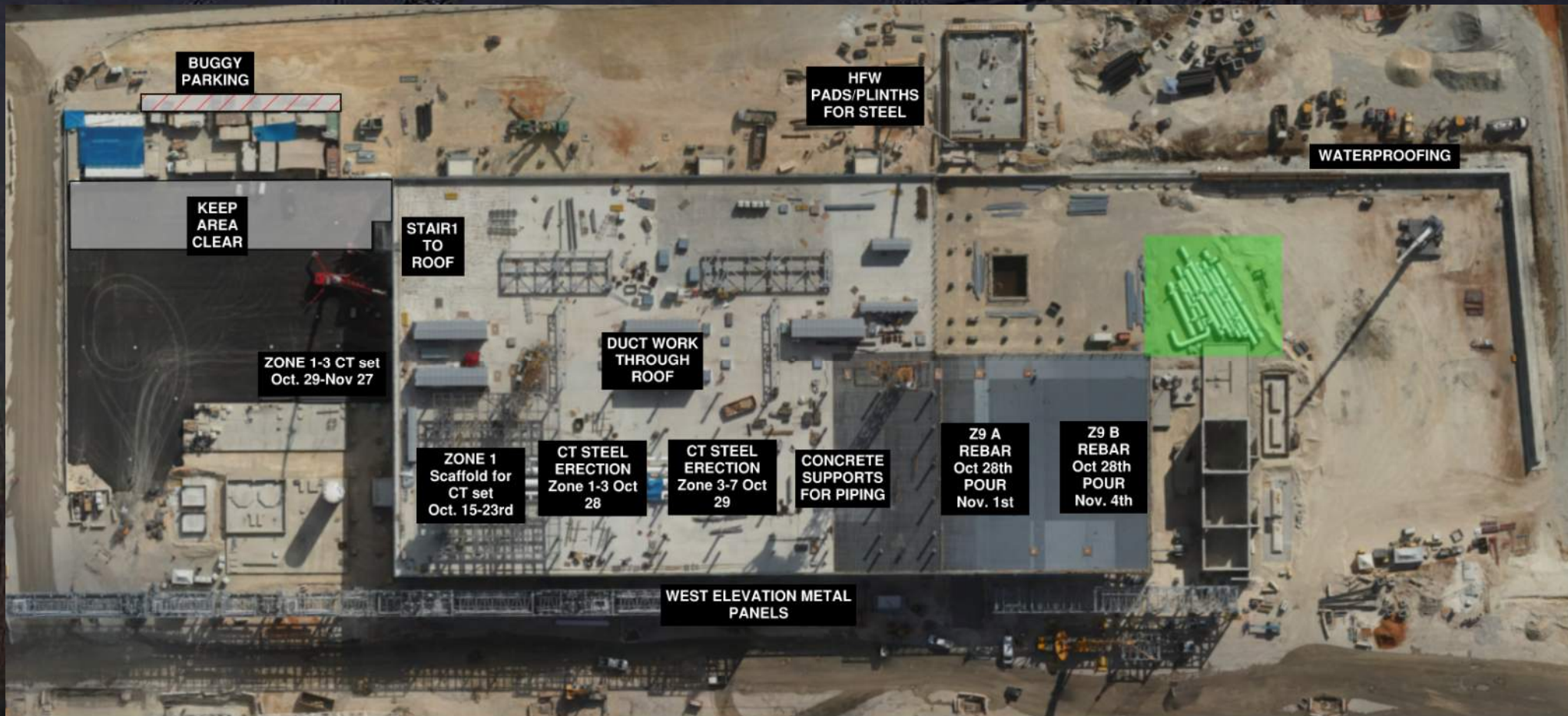



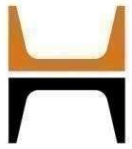

**HOFFMAN CONSTRUCTION COMPANY**

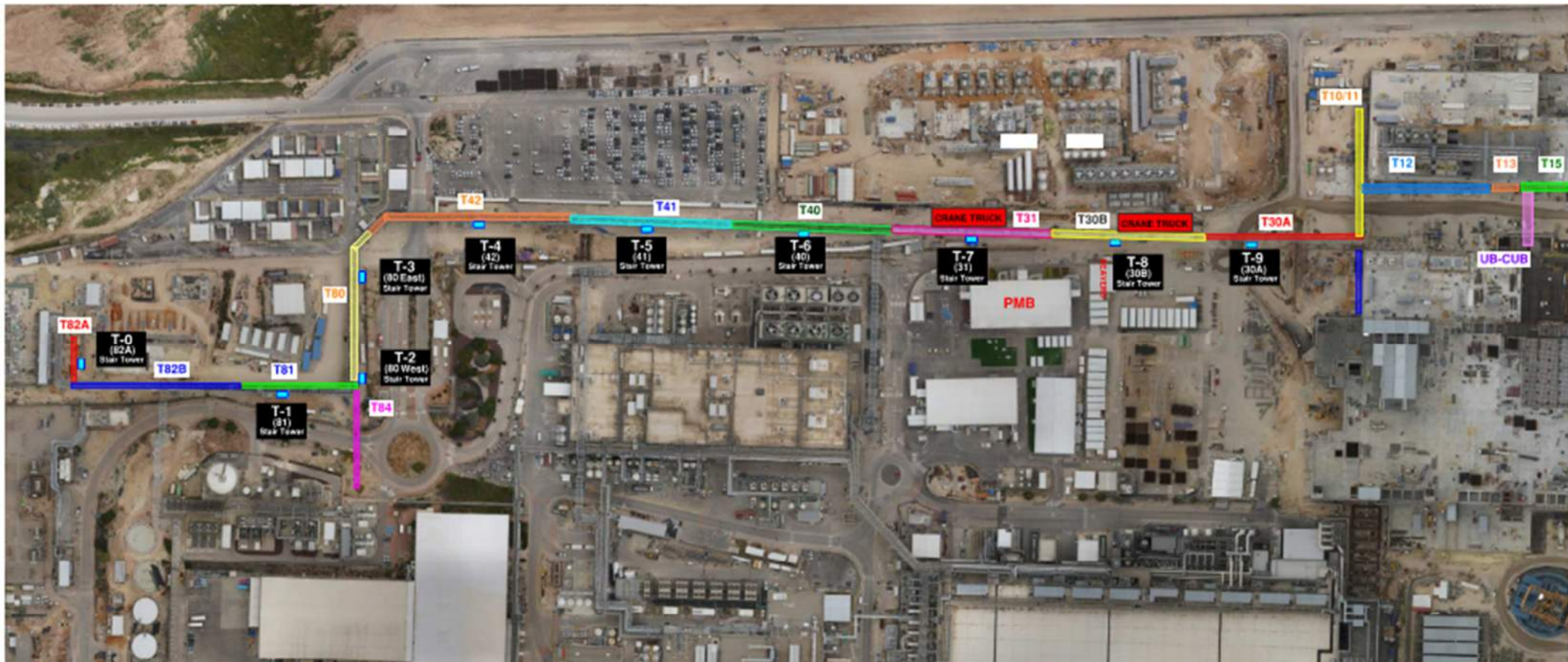



T18

CUB 2 - NOV 3th - NOV 11rh

nov 7th

nov 6th

nov 5th

nov 3th

nov 10th

nov 11th





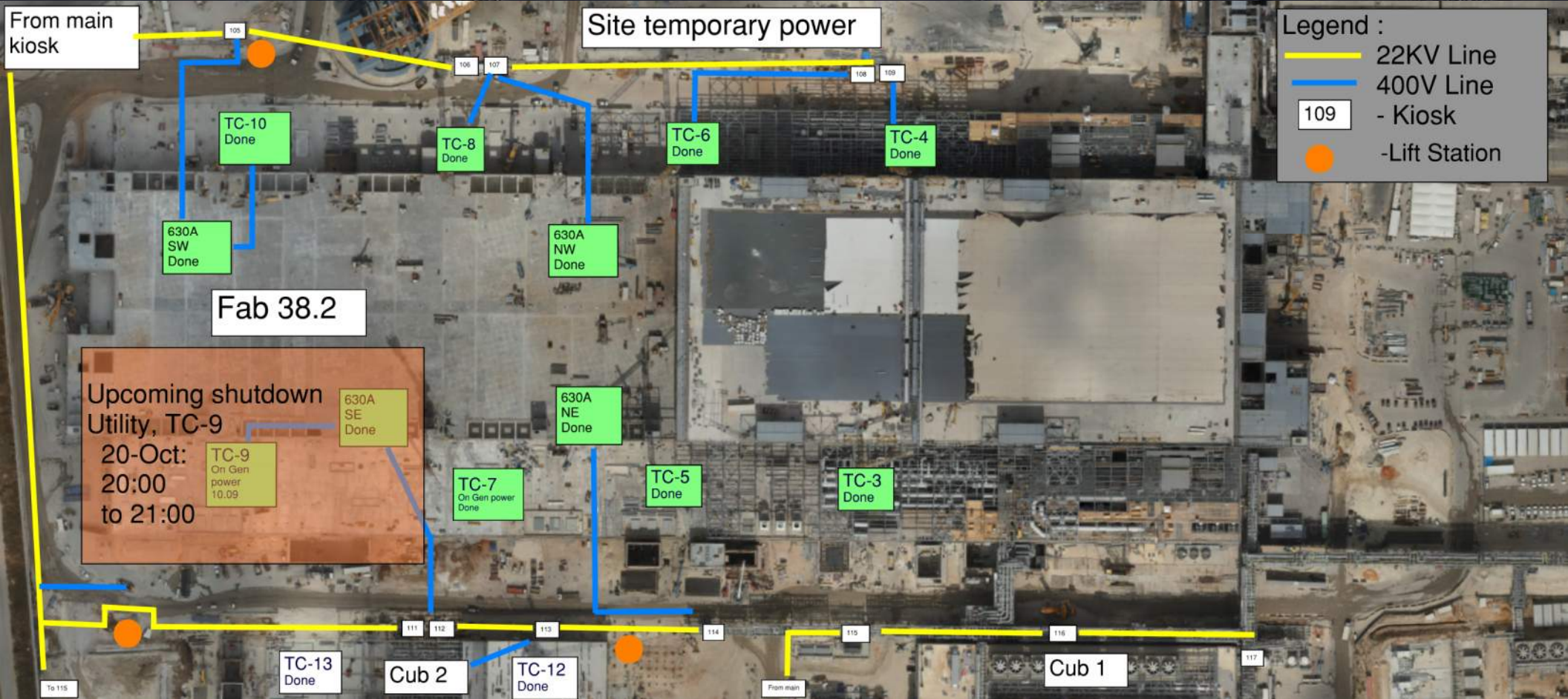





# Daily Coordination Meeting

## Site Logistics

### North

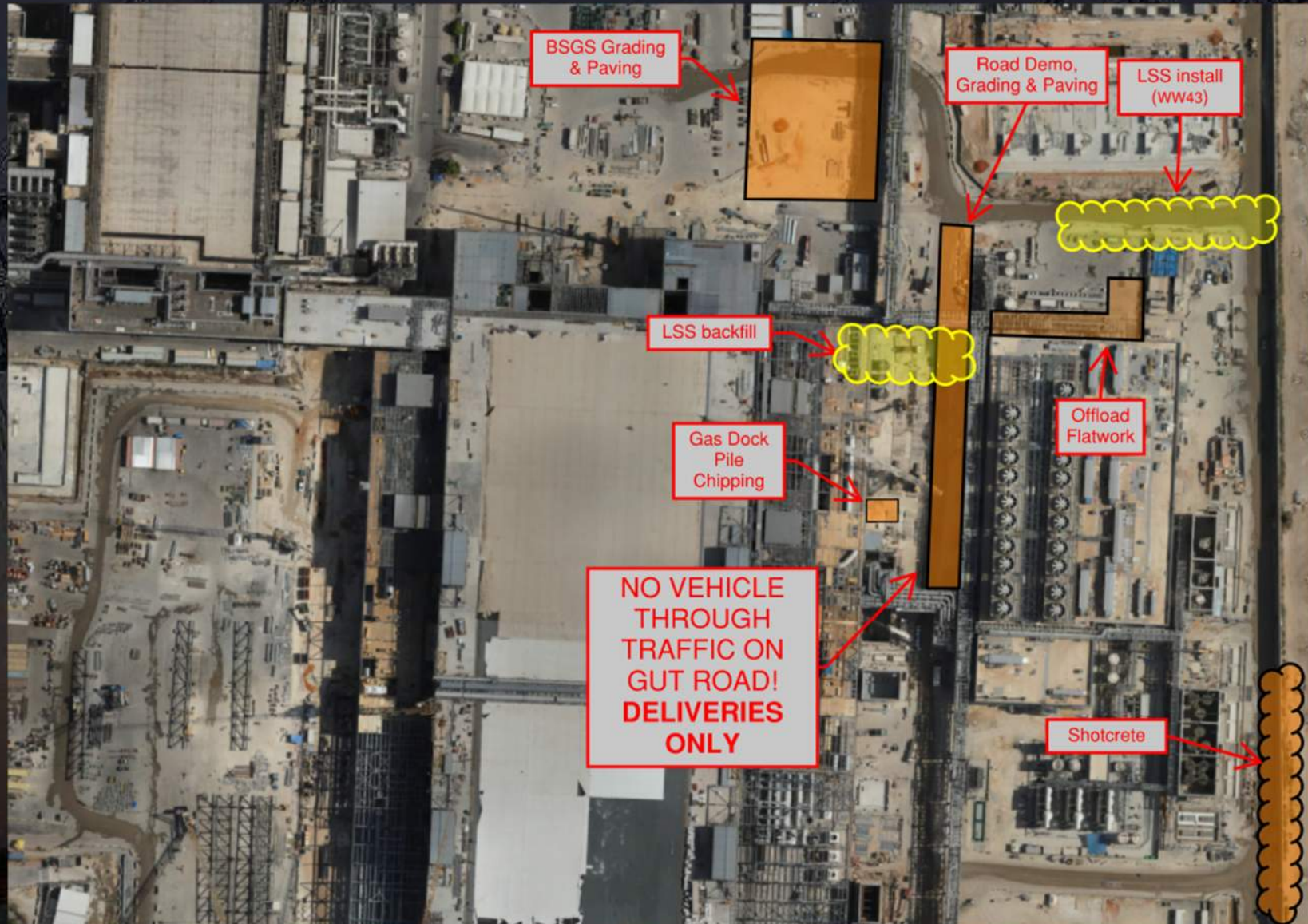





# Daily Coordination Meeting

## Site Logistics

### South

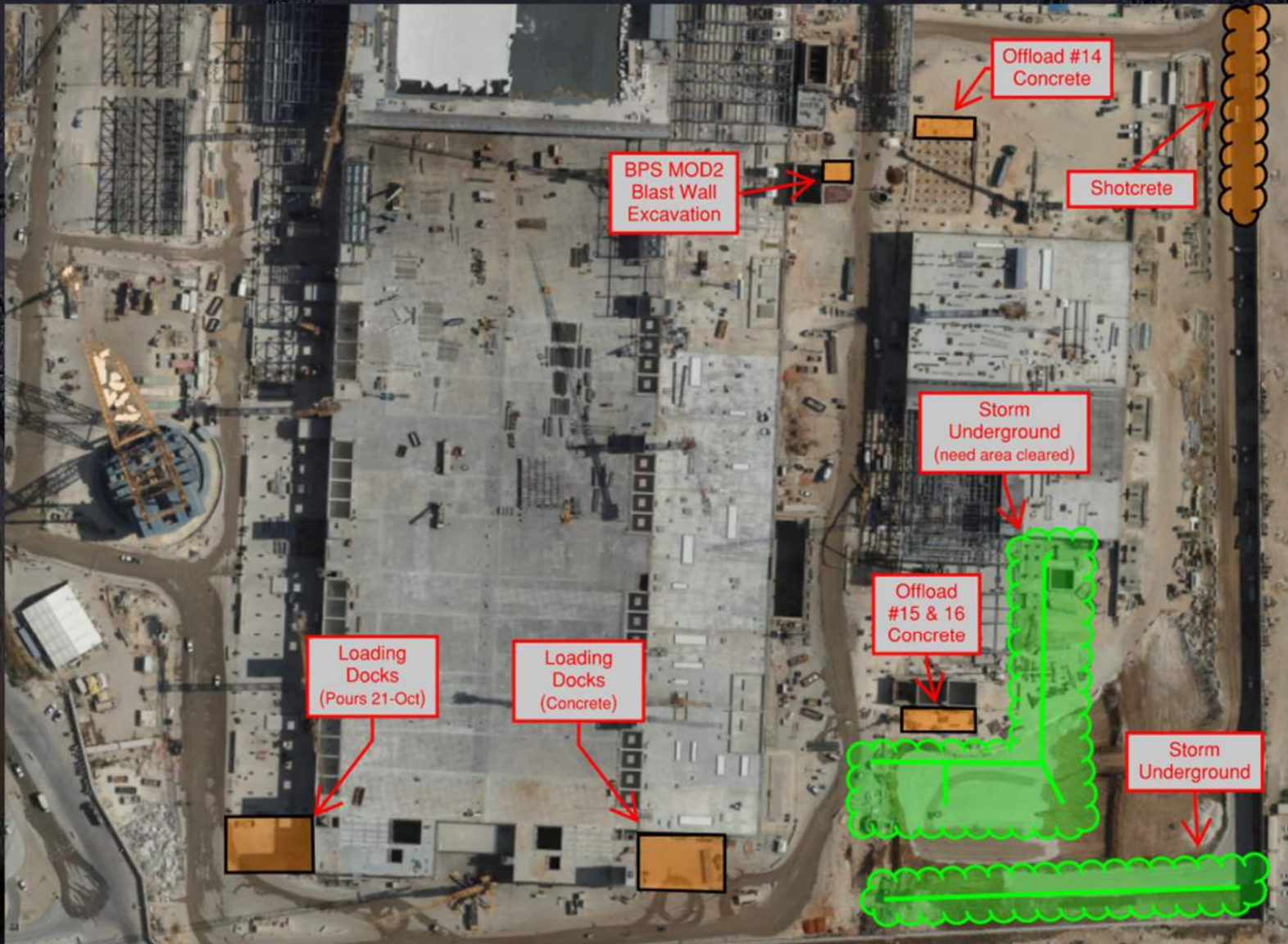



# All Incidents Must Be Reported

- On this project it is a requirement that all incidents are reported, this includes near misses.
- The intention with this is to ensure that we don't have unsafe behaviors and conditions in the field unaddressed.
- It is also to facilitate learning from everything.
- If we do not analyze an incident, then we can't be sure that we are learning and adjusting our methods to prevent similar incidents from occurring.
- We also have a duty to share lessons learned to other subcontractors on site, hence the need to report.



# Daily Coordination Meeting



14:00 Sign In